

MAXMOD

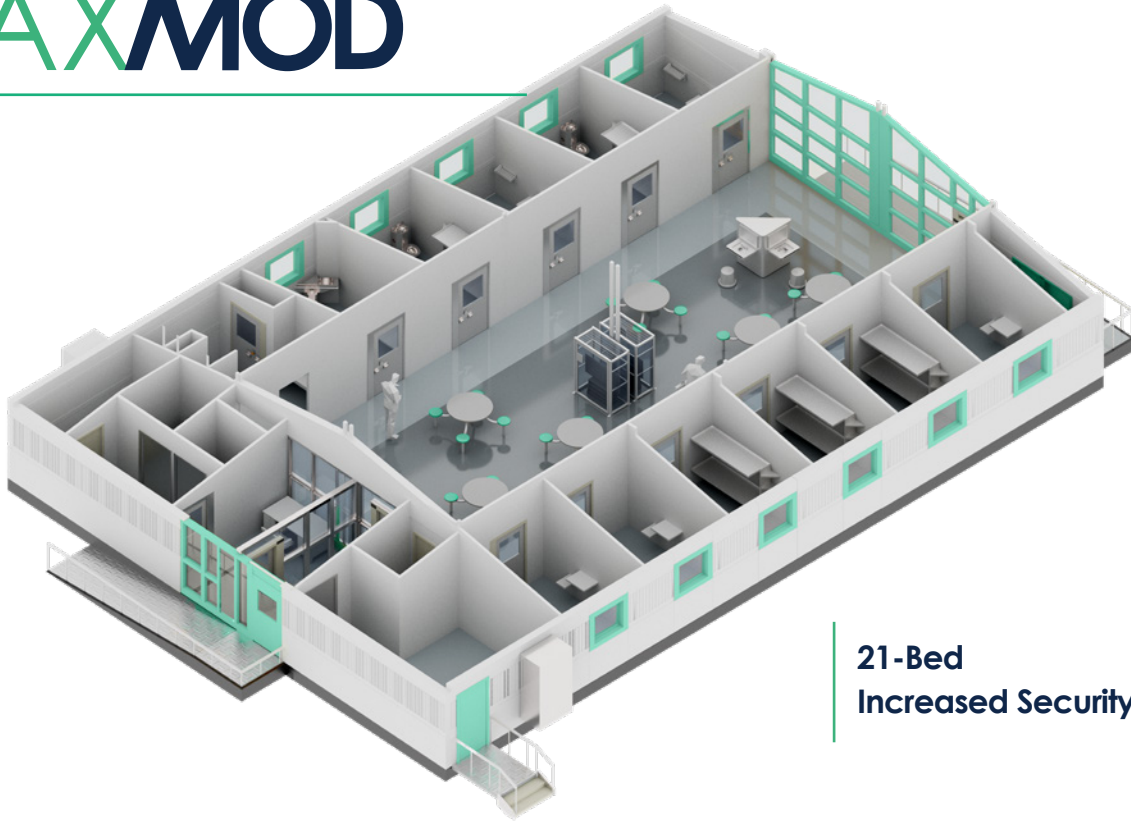

**21-Bed
Increased Security Unit**

MEDIUM/MAXIMUM SECURITY HOUSING UNITS

MODEL

MAXMOD 21-bed housing unit is fully furnished and ready for delivery and assembly for turnkey operational use.

APPLICATIONS

- COUNTY JAILS
- DETENTION & HOLDING FACILITIES
- FEDERAL & STATE MODULAR PRISONS
- JUVENILE DETENTION CENTERS
- EMERGENCY RESPONSE



CODE COMPLIANT

National Building Code, National Energy Code, ADA Requirements, ACA Compliant



CONSTRUCTION MATERIALS

- All steel construction using
- ASTM Tested & Approved Doors, Frames, Walls & Ceilings
 - Detention Grade Locks & Hardware
 - Rated Glazing



SECURITY ELECTRONIC SYSTEMS

- Video Surveillance & Management Systems
- Electronic Lock Controls
- Intercom/Paging Communications
- Video Visitation Control Console



FLEXIBILITY

Constructed on skids to assemble easily on-site within 30 days for immediate occupancy

BUDDY JOHNS
bjohns@modcorr.com

832.829.4262
modcorr.com



ADAPTABILITY

This Modular Unit is adaptable to increase capacity through the incremental addition of modules. Pod control is designed to manage up to 80 beds. Multiple control pods, each managing up to 80 beds, can be incrementally linked for housing campuses up to 800 beds.

SIZE AND CAPACITY

Unit	Dimensions	Sq. Ft.
Assembled Housing Units	48' x 68'	3,264
10 Standard Cells per Unit	8' x 12'/ea	96/ea
1 ADA Cell	8' x 12'	96
1 3-Shower Unit	12' x 12'	144
1 Dayroom	24' x 55'	1,344

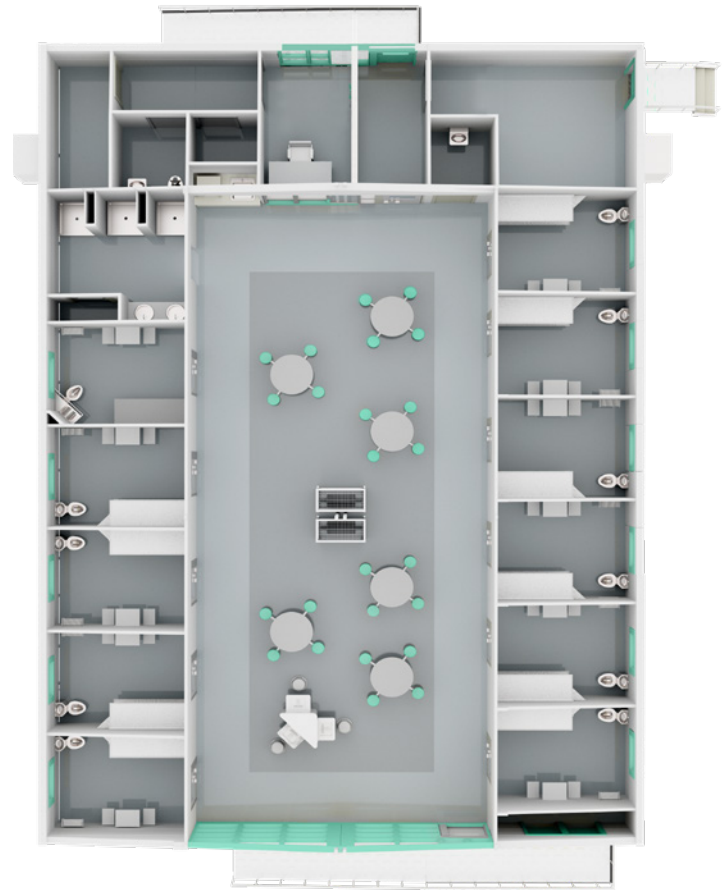

DESIGN CONSIDERATION ADOPTED

- Durability – powder coating on epoxy coated finishes throughout
- Furniture, fixtures & finishes all have anti-ligature & contraband resistant designs
- Detention grade LED lighting throughout
- Line of site consideration from control room
- Ample AC/heating & ducted returns to ensure adequate air & ventilation
- Natural lighting
- Building secure envelope

BUDDY JOHNS
bjohns@modcorr.com

832.829.4262
modcorr.com

